



© Miran Kambi?

Located on the outskirts of Maribor, the building is a wholesale warehouse for medicines. It is divided into an administrative part and a warehouse, linked by a covered courtyard for handling products. The main facade of the administrative part is slightly curved, so as to add to the dramatic perspective one perceives when accessing the building from the side. The materials and technology are used intelligently: the assembly facade panels also serve as heating bodies, while on the lateral facades the glass panes are used as facade panels, to which further structure is added by means of partially visible thermal insulation. By assuming more complex functions, individual elements remain very pure formally, giving the building a touch of elegance.

Head offices and warehouse Farmadent

Mina?ikova ulica 6
2000 Maribor, Slowenien

ARCHITEKTUR
Anton Lešnik

BAUHERRSCHAFT
Farmadent d.o.o.

TRAGWERKSPLANUNG
Sre?ko Bani?

ÖRTLICHE BAUAUFSICHT
Konstruktor d.d.

FERTIGSTELLUNG
1995

SAMMLUNG
Architekturarchiv Slowenien

PUBLIKATIONSdatum
19. März 2006



**Head offices and warehouse
Farmadent**

DATENBLATT

Architektur: Anton Lešnik

Mitarbeit Architektur: Tone Turk

Bauherrschaft: Farmadent d.o.o.

Tragwerksplanung: Srečko Banič

örtliche Bauaufsicht: Konstruktor d.d.

Fotografie: Miran Kambič

Funktion: Gemischte Nutzung

Planung: 1993 - 1995

Ausführung: 1993 - 1995

Bebaute Fläche: 6.000 m²

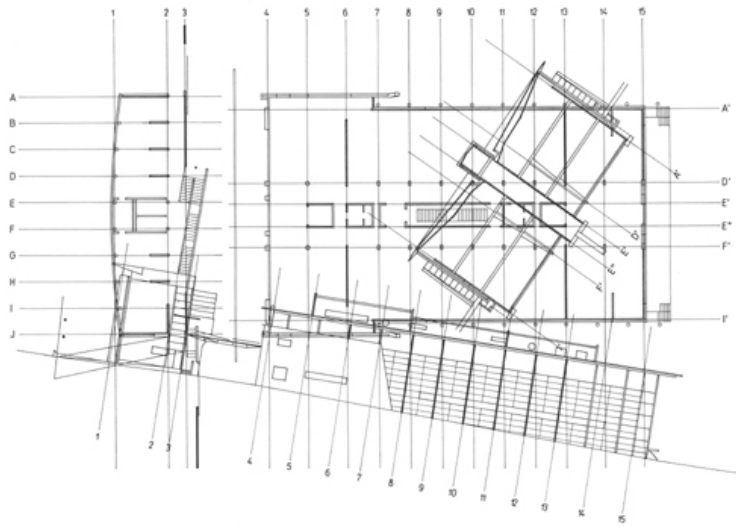

jpg

**Head offices and warehouse
Farmadent**

plan