



© Matej Vozli?

The layout of the Dvorni trg square and the Hribarjevo nabrežje river banks is part of the broader design for the transformation of public areas along the Ljubljanica River, which has evolved gradually over the past decade. The layout of Hribarjevo nabrežje emphasises the flow of the river and continues, with pergolas and trees, to stress the Mediterranean features of the town, a principle earlier followed by Plešnik. Dvorni trg, a former parking area, is transformed into a useful urban space by means of step-cascades. The necessary access to collectors in the lower part of the square dictated the design of a wooden platform, which acts as a stage against the background silhouette of the Ljubljana Castle.

Dvorni trg and Hribarjevo nabrežje

Dvorni trg
1000 Ljubljana, Slowenien

ARCHITEKTUR
Matej Vozli?
Vesna Vozli?

BAUHERRSCHAFT
Town of Ljubljana

FERTIGSTELLUNG
2002

SAMMLUNG
Architekturarchiv Slowenien

PUBLIKATIONSdatum
19. Februar 2006



© Matej Vozli?

Dvorni trg and Hribarjevo nabrežje

DATENBLATT

Architektur: Matej Vozli?, Vesna Vozli?

Mitarbeit Architektur: Mateja Križej, Klemen Vodnik, Tomaž Slak

Bauherrschaft: Town of Ljubljana

Maßnahme: Neubau

Funktion: Parkanlagen und Platzgestaltung

Planung: 1995 - 2000

Fertigstellung: 2002

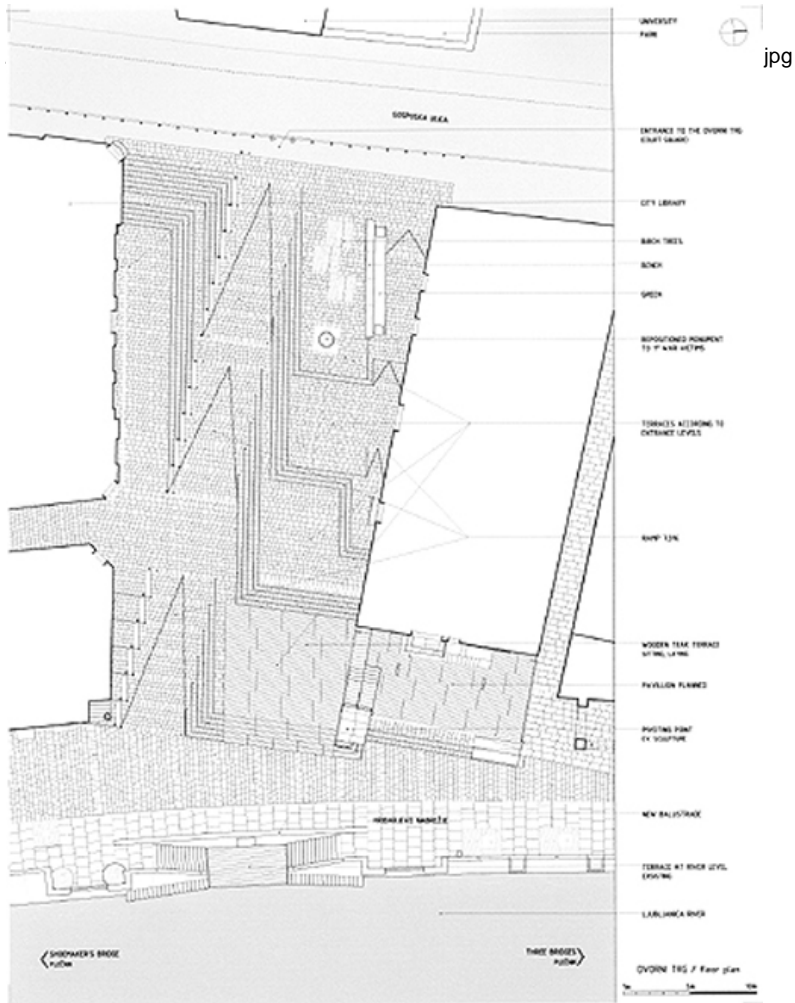

Dvorni trg and Hribarjevo nabrežje

plan